

**DESCRIPTION**  
BEING PART OF AN UNNUMBERED LOT OF HIGHLAND ACRES SUBDIVISION NO. 2 AND PART OF THE LANDS OF UPPER SANDUSKY, SOUTHEAST QUARTER, SECTION 20 AND PART OF THE NORTHEAST QUARTER, SECTION 29, TOWNSHIP 2 SOUTH, RANGE 13 EAST, CRANE TOWNSHIP, WYANDOT COUNTY, OHIO.

CURVE TABLE					
CURVE #	LENGTH	RADIUS	DELTA	CHORD DIRECTION	CHORD LENGTH
C1	60.41'	575.00'	6°01'12"	N 31° 35' 21" W	60.39'
C2	114.75'	125.00'	52°35'58"	N 80° 20' 43" E	110.77'

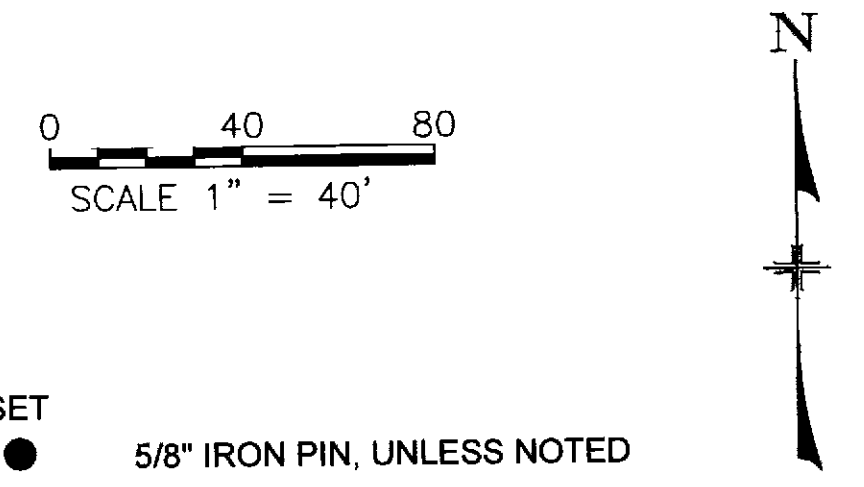

- LEGEND**
- |       |     |                              |
|-------|-----|------------------------------|
| FOUND | SET |                              |
| ○     | ●   | 5/8" IRON PIN, UNLESS NOTED  |
| ⊗     | ●   | 5/8" IRON PIPE, UNLESS NOTED |
| △     | ▲   | RAILROAD SPIKE               |
| □     | ●   | SURVEY NAIL                  |
| ◇     | ●   | MAG SPIKE                    |

- NOTES**
- ALL IRON PINS SET ARE 5/8" x 30" LONG REINFORCING RODS WITH YELLOW PLASTIC CAPS STAMPED "MAKEEVER AND ASSOC." UNLESS OTHERWISE NOTED.
  - BEARINGS SHOWN HEREON ARE TO AN ASSUMED AZIMUTH AND ARE USED TO DENOTE ANGLES ONLY.
  - THE PROPERTY SHOWN HEREON THIS PLAT OF SURVEY IS SUBJECT TO ALL HIGHWAYS, EASEMENTS, AND RESTRICTIONS OF RECORD. THIS SURVEY IS NOT INTENDED TO SHOW EASEMENTS AFFECTING THE PROPERTY.
  - TRACT A CAN ONLY BE TRANSFERRED TO AN ADJOINER ONLY.

**SURVEYOR'S STATEMENT**  
I HEREBY STATE TO UPPER UNITED DEVELOPMENT CORP., THAT THE DRAWING HEREIN IS REPRESENTATIVE OF AN ACTUAL SURVEY PERFORMED IN SEPTEMBER, 2019, BY MAKEEVER AND ASSOCIATES UNDER MY DIRECT SUPERVISION AND THAT ALL INFORMATION IS TRUE AND CORRECT TO THE BEST OF MY KNOWLEDGE AND BELIEF.

*Isaac L. King*  
ISAAC L. KING, P.S.  
PROFESSIONAL SURVEYOR NO. 8318  
DATE: 9-23-2019

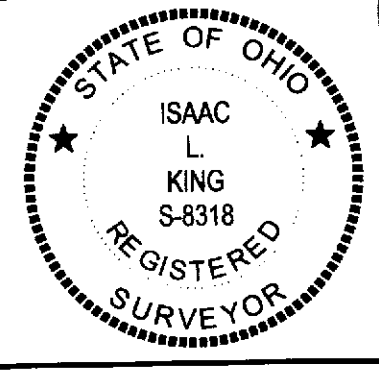

**SURVEY REFERENCES**  
PLAT CAB. A, SLIDE 466  
PLAT CAB. A, SLIDE 608

**ACREAGE SUMMARY**

SECTION 20	0.191 ACRES
SECTION 29	0.396 ACRES
THIS SURVEY	0.587 ACRES

**Makeever & Associates, Inc.**  
P.O. BOX 325, 1810 E. MANSFIELD ST.  
BUCYRUS, OHIO 44820  
Phone: (419) 562-7757 Fax: (419) 562-4717

PLAT OF SURVEY FOR:  
**UPPER UNITED DEVELOPMENT**

ORIG. DATE: 9-23-2019	S:\2018\127
ORIG. SHEET SIZE = 18"x24"	DWG. NAME : 2018-127-002 Gps

SURVEY NUMBER: 19-61  
VOLUME: D PAGE: 630  
DATE FILED: 10-1-19  
PARCEL #: 06-4502-4800-00

ALL REGIONAL PLANNING  
REQUIREMENTS HAVE BEEN  
APPROVED FOR THIS SURVEY  
APPLICATION # 1114